

II VARIANTE AL PIANO DELLE REGOLE E AL PIANO DEI SERVIZI DEL VIGENTE PIANO DEL GOVERNO DEL TERRITORIO

Redatto ai sensi della Legge Regionale 11 marzo 2005, n. 12

Piano delle Regole
TAVOLA: 2b Nuclei Antichi

FASE: ADOZIONE
Modalità di intervento in zona A

1:1.000

PIANO DI GOVERNO DEL TERRITORIO

PROGETTISTA
 Comune di Serle
 Responsabile Area Edilizia Privata Urbanistica e Ambiente
 Arch. Massimiliano Lopodoto
 Con il supporto di Secoval s.r.l.
 Arch. Lucrezia Franzoni
 Pian. Francesca Marano

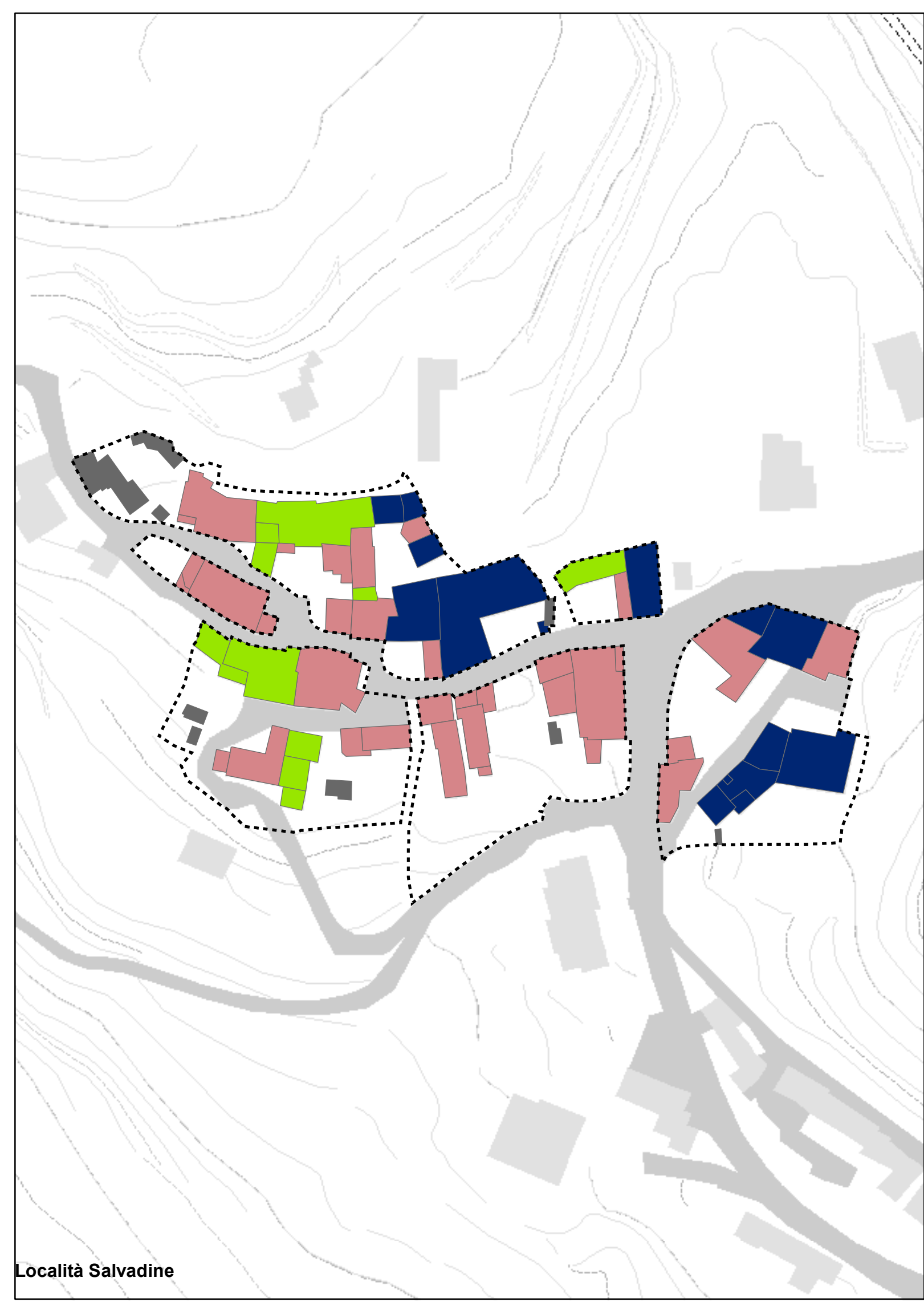

Località Salvadine

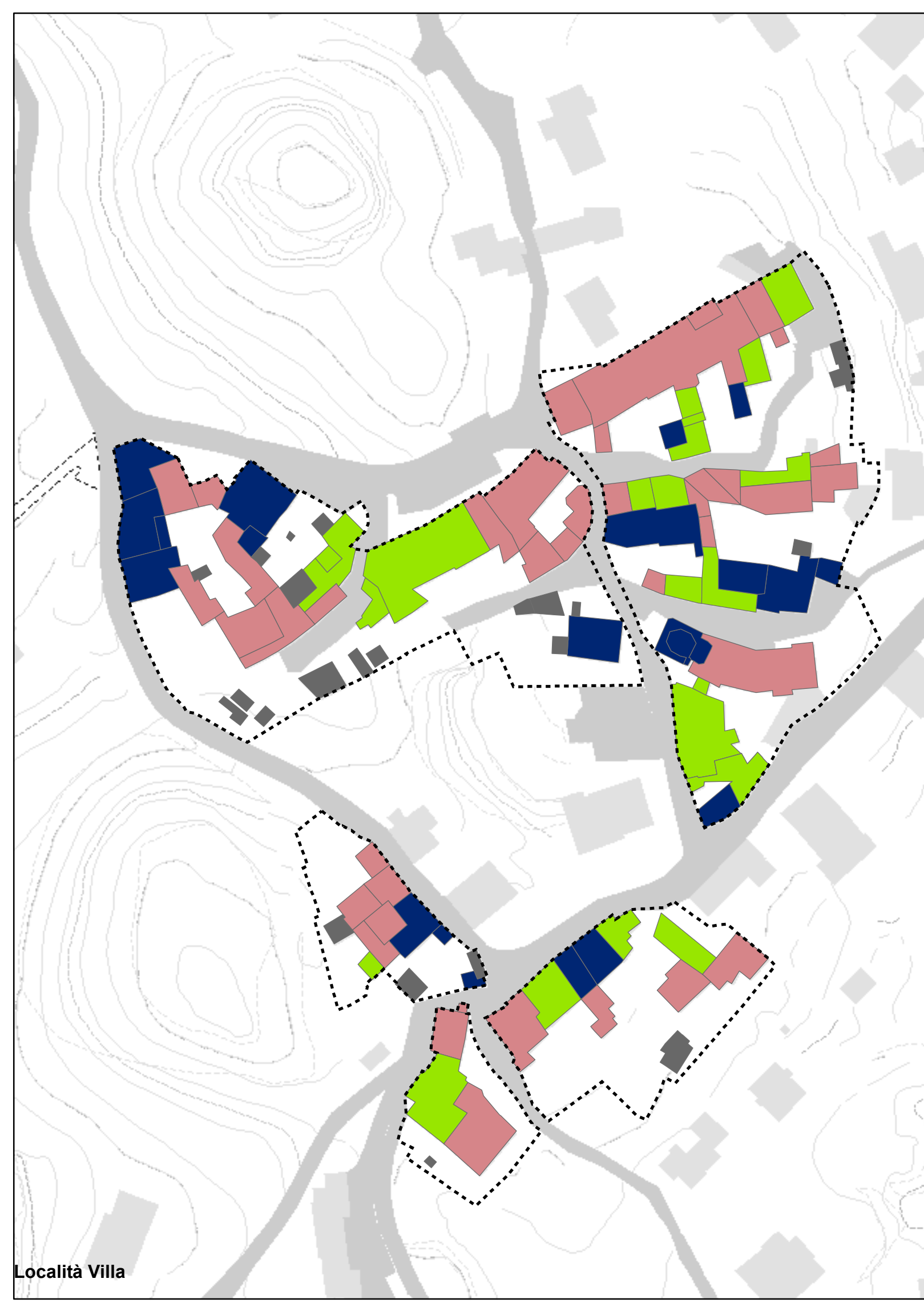

Località Villa



Località Bornidolo

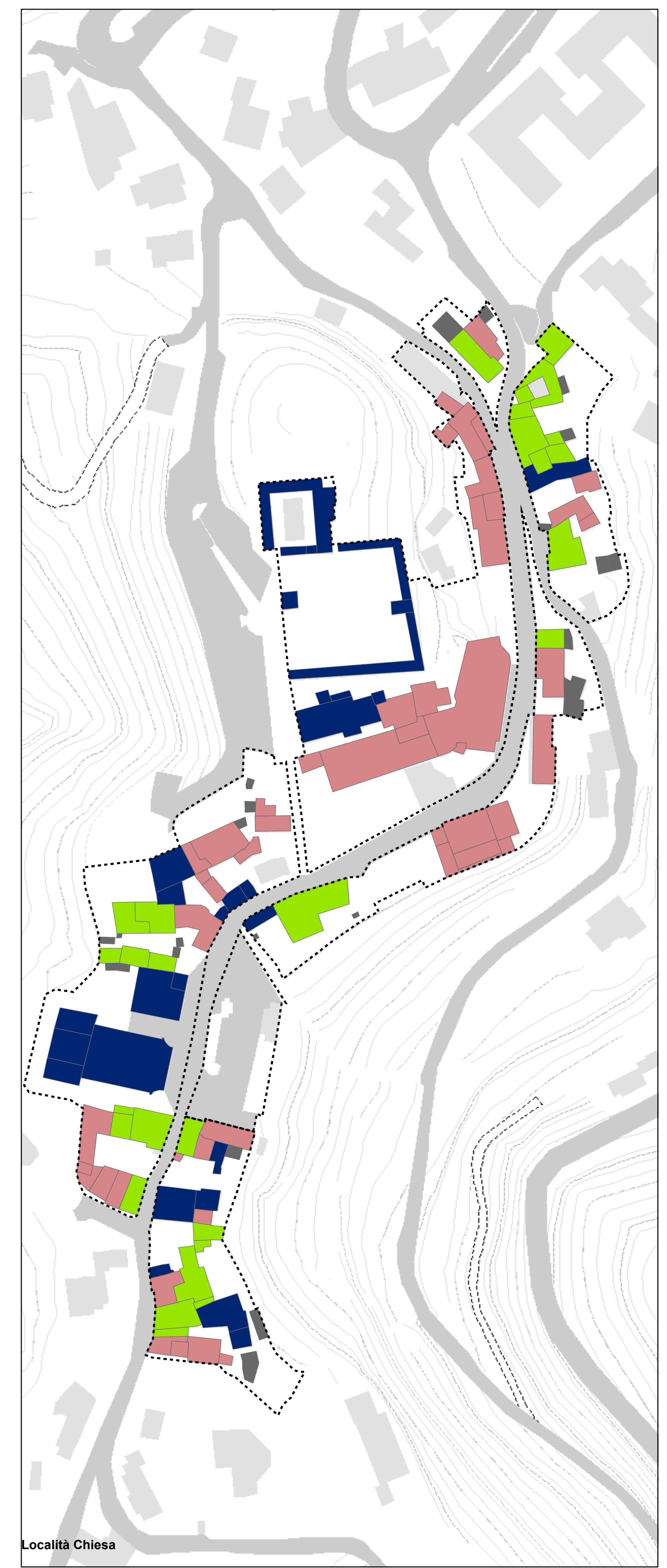

Località Chiesa

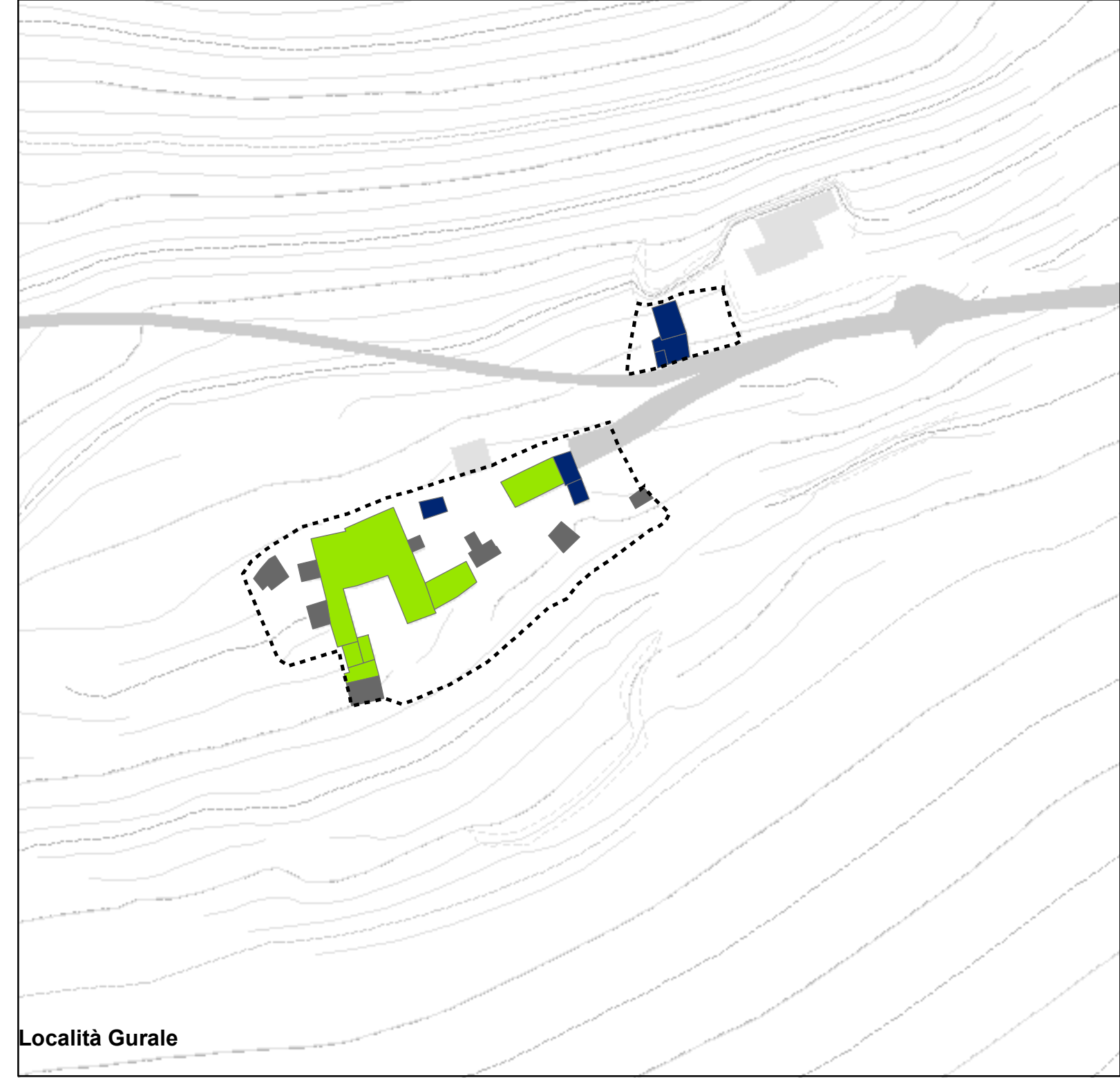

Località Gurale

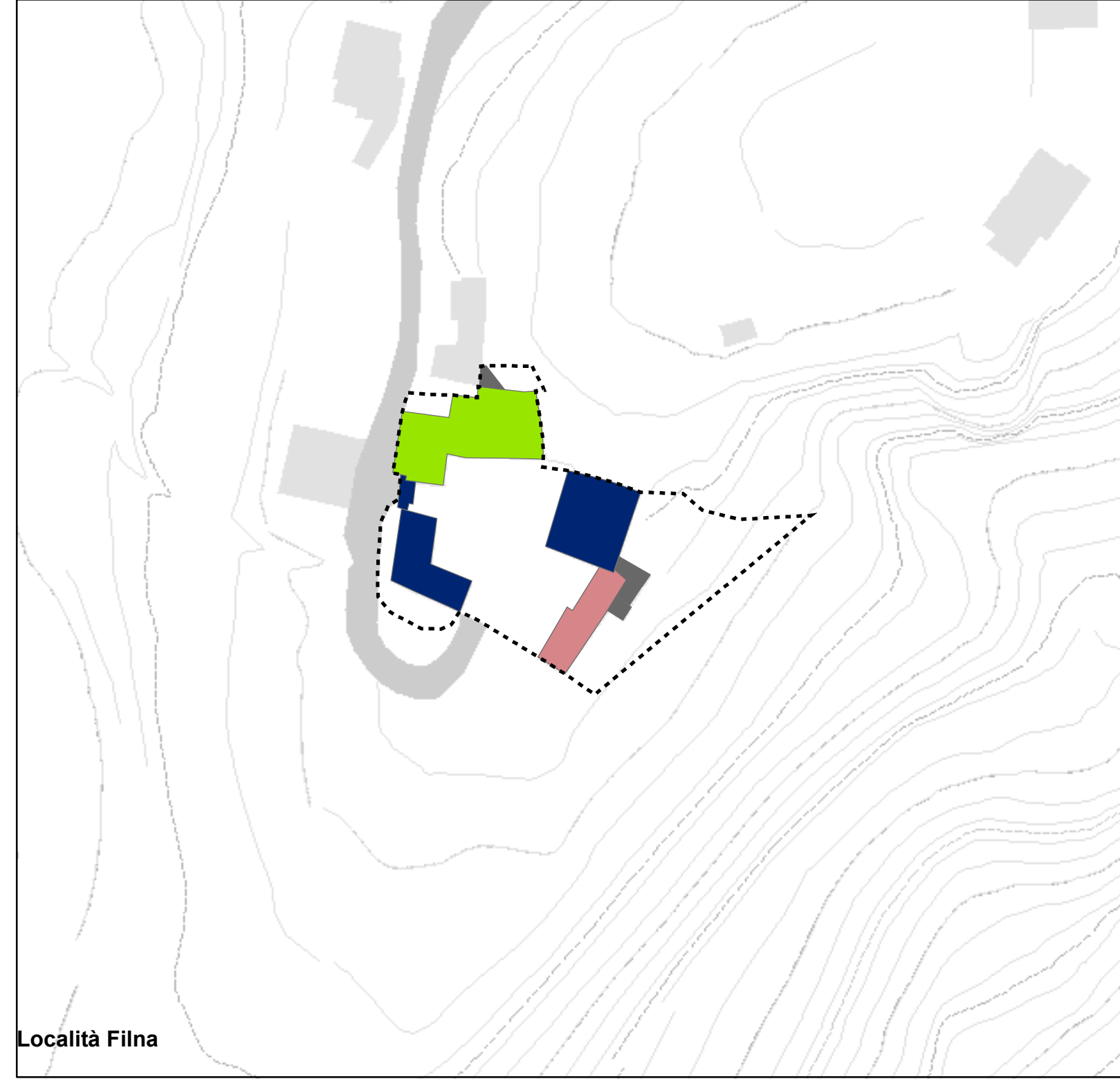

Località Filina

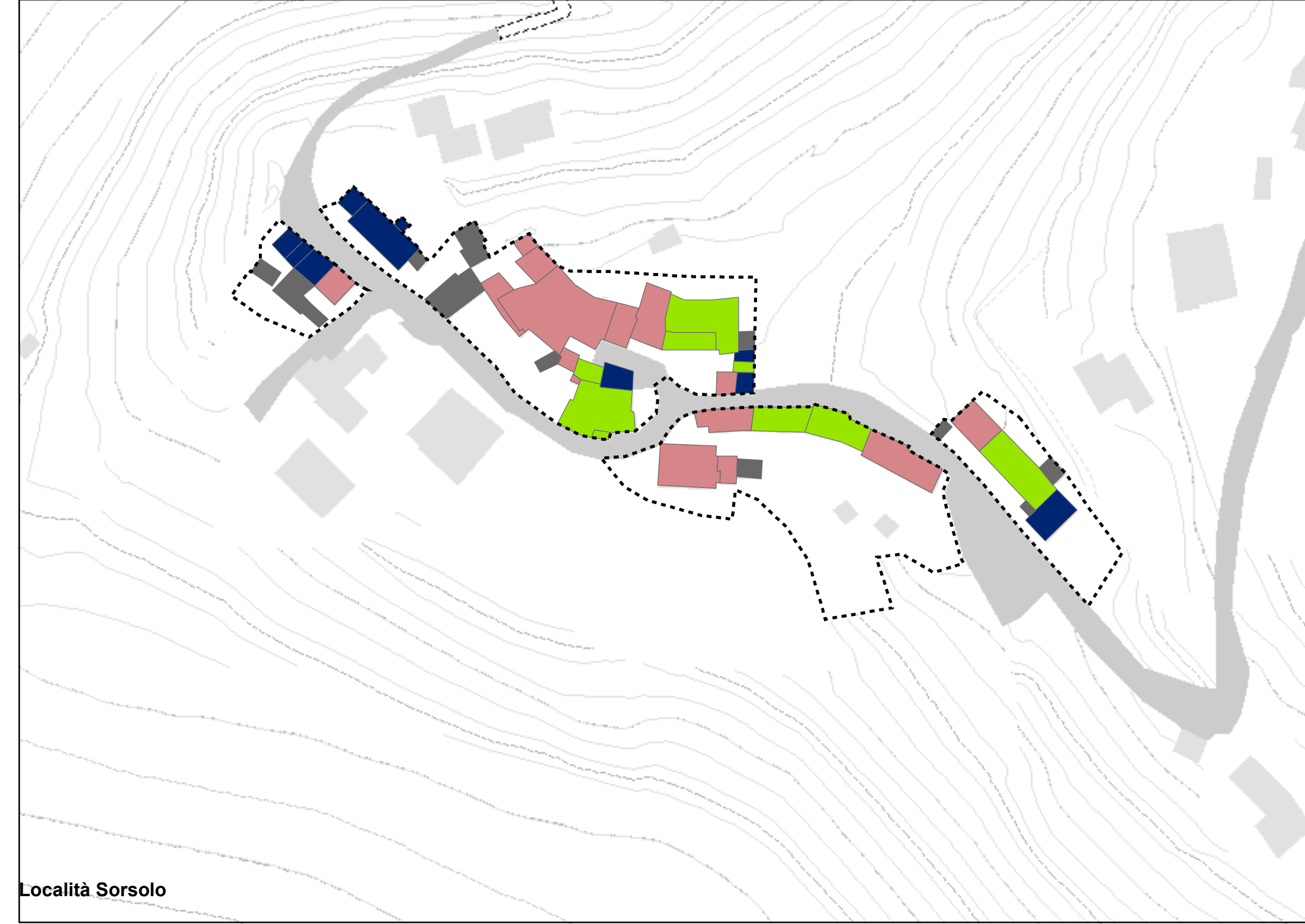

Località Sorsolo

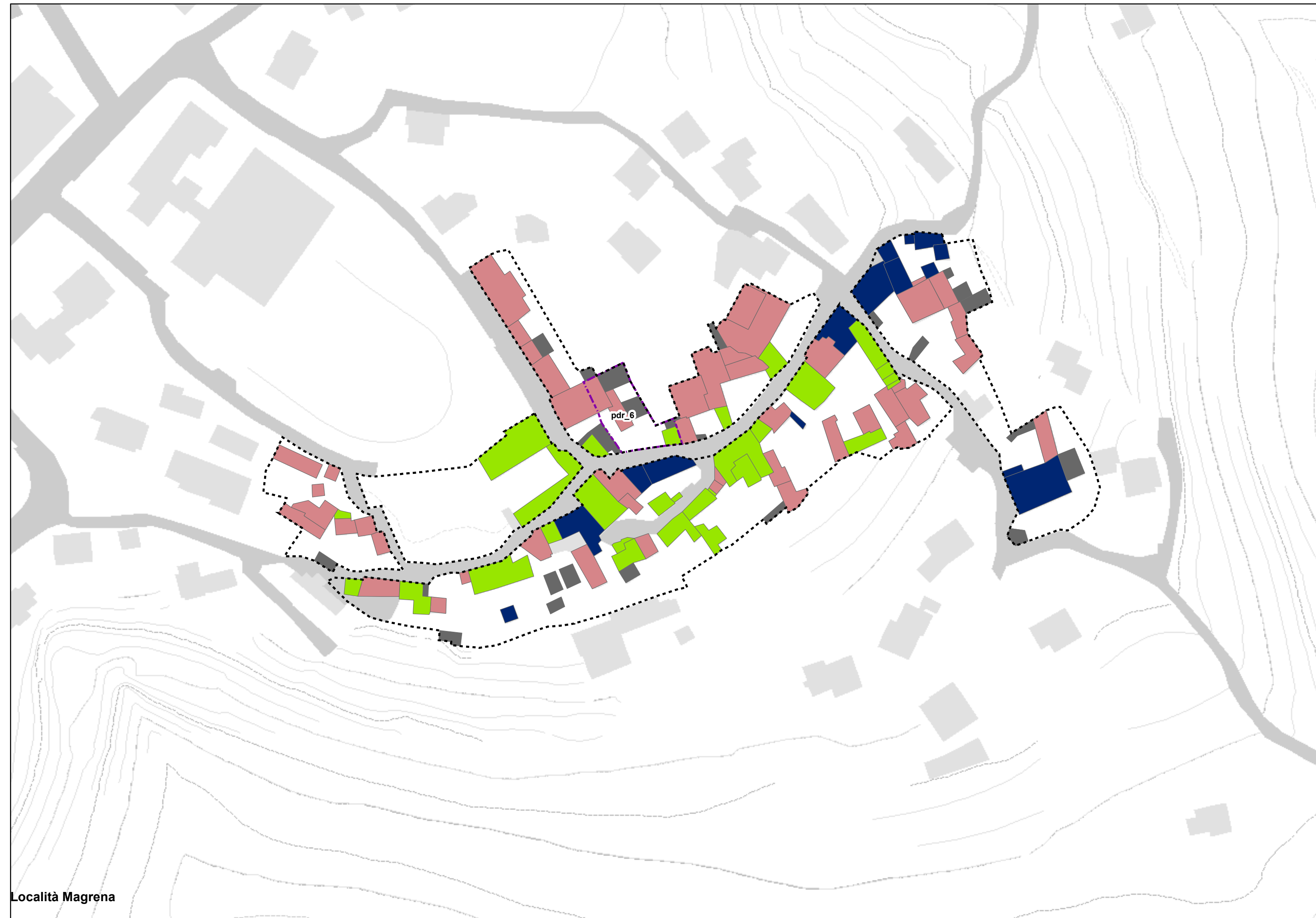



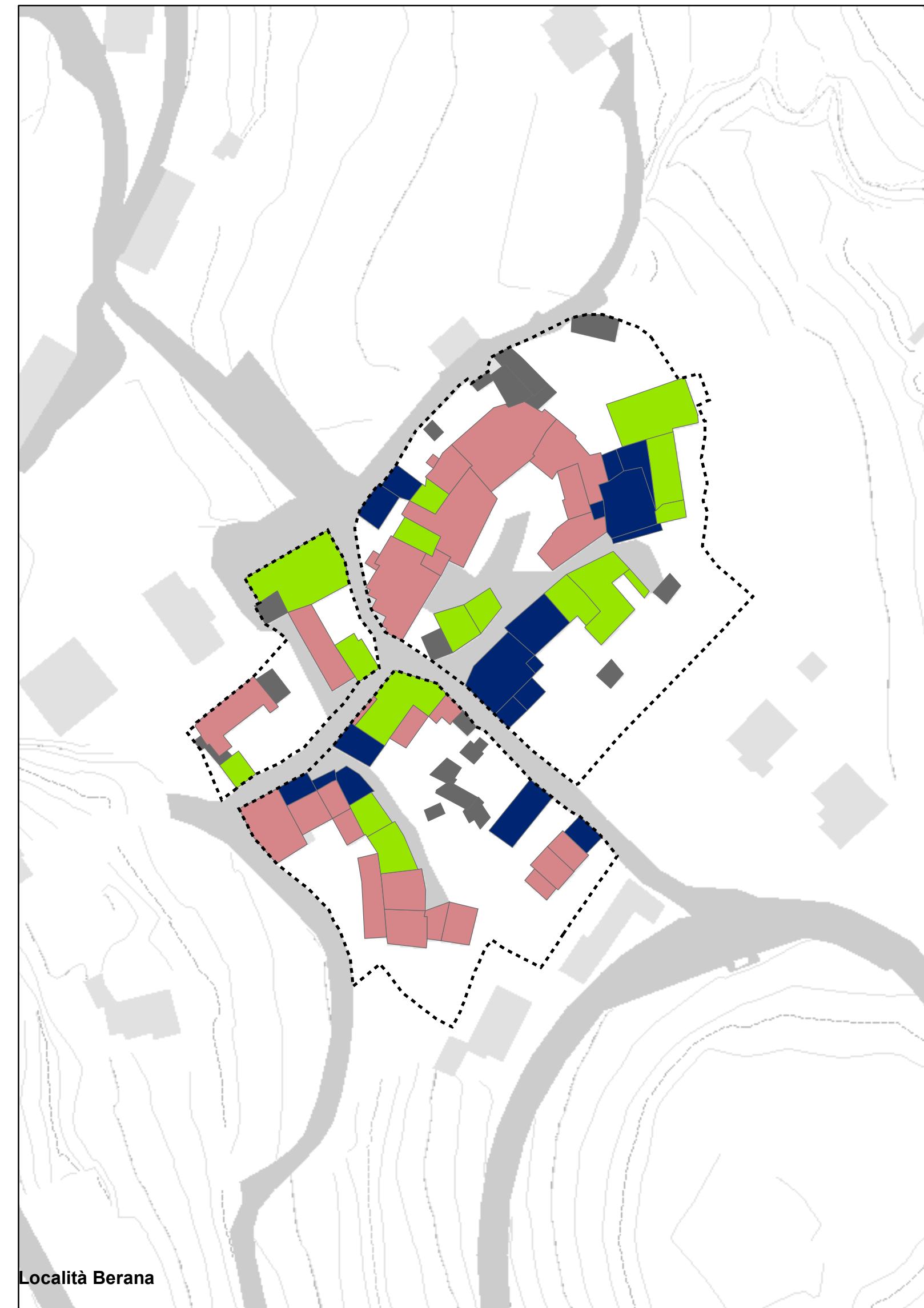

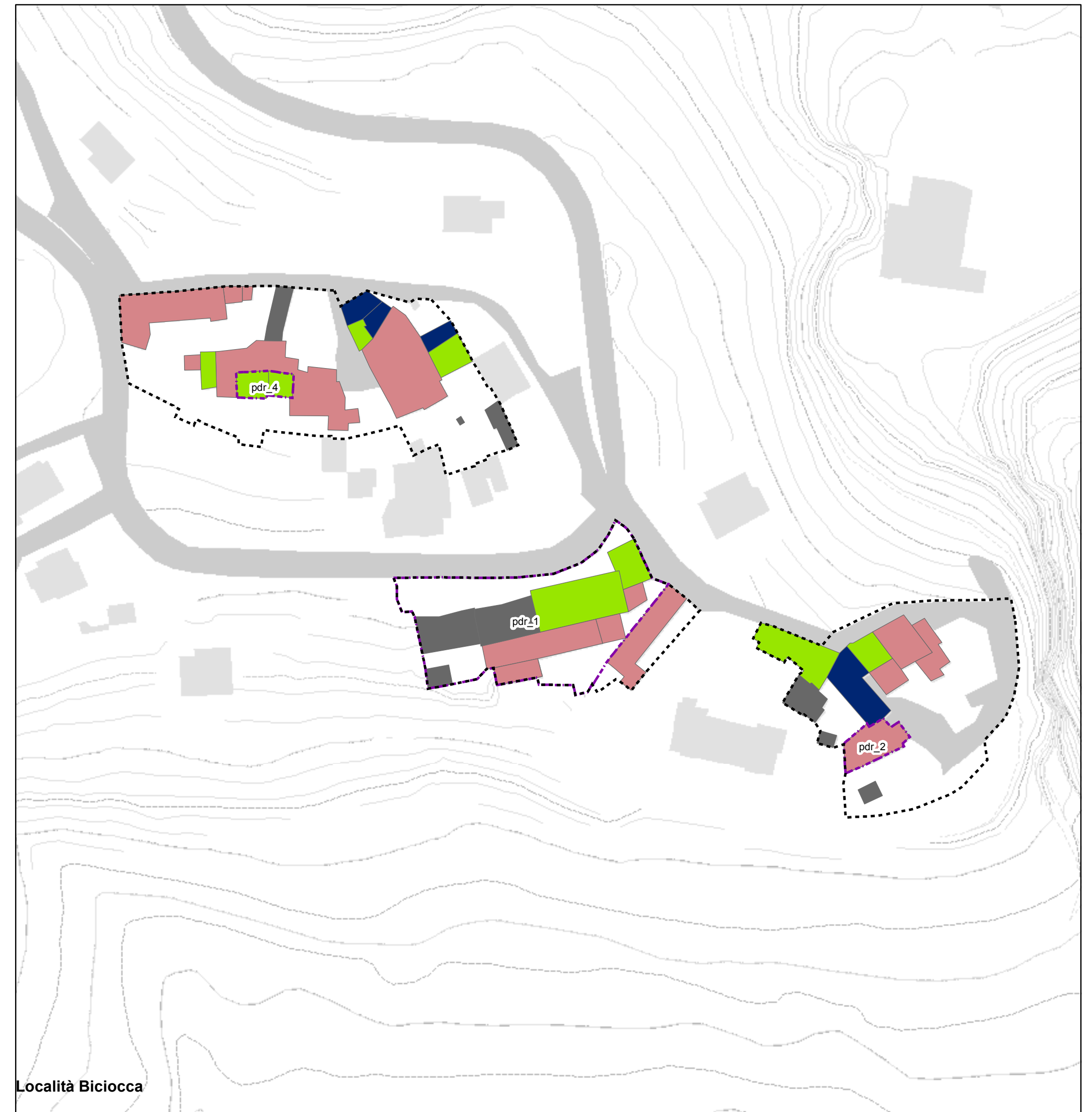

Località Magrena



Località Berana



Località Biciocca

- Legenda**
-  Perimetro Zona A Nuclei Antichi
 -  Aree di recupero soggette a Piano Attuativo (PdR)
 -  Accessori
 -  Classe 1 - Classe 2 - Classe 3 - Restauro e Risanamento conservativo
 -  Classe 4 - Manutenzione straordinaria
 -  Classe 5 - Ristrutturazione edilizia